

HS-210S Temperature Sensor

only temperature output via 3 Pin MS Connector

Key Features

- Temperature output
- For use with data collector
- Side entry for easy access

Industries

Building services, Pulp and Paper,
Mining, Metals, Utilities, Automotive,
Water, Pharmaceutical

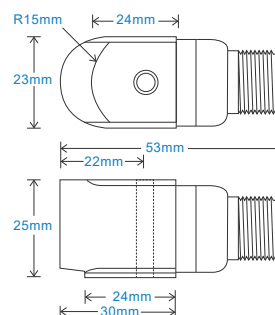

Connection Details

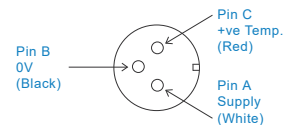

Technical Performance

Temperature Output 10 mV/°C standard 100°C - Option 150°C
Isolation Base isolated

Mechanical

Case Material Stainless Steel
Mounting Torque 8Nm
Mounting Bolt provided see: 'How To Order' table x 30mm long
Weight 125gms (nominal) body only
Screened Cable Assembly see: www.hansfordsensors.com for options
Connector HS-AA005 - non-booted
HS-AA068 or HS-0069 - booted
Mounting Threads see: 'How To Order' table

Electrical

Operating Voltage 4-30 VDC

Environmental

Operating Temperature Range -55 to see: 'How To Order' table for max
Sealing IP68
EMC EN61326-1:2013

Applications

Fans, Motors, Pumps, Compressors,
Centrifuges, Conveyors, Air Handlers,
Gearboxes, Rolls, Dryers, Presses,
Cooling, VAC, Spindles, Machine Tooling,
Process Equipment

Vibration sensor should be firmly fixed to a flat surface
(spot face surface may be needed to be produced and
cable anchored to sensor body.)

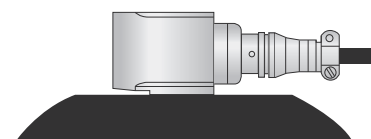

How To Order

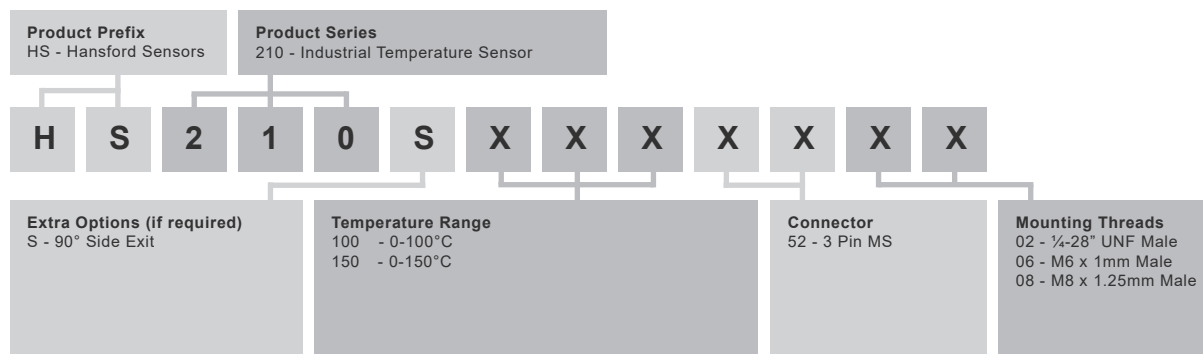

www.hansfordsensors.com
sales@hansfordsensors.com

We reserve the right to alter the specification of this product without prior notice
TS388.7



HS-210S Temperature Sensor

only temperature output via 4 Core Screened Polyolefin HFFR with Protective Conduit

Key Features

- Temperature output
- For use with data collector
- Side entry for easy access

Industries

Building services, Pulp and Paper,
Mining, Metals, Utilities, Automotive,
Water, Pharmaceutical

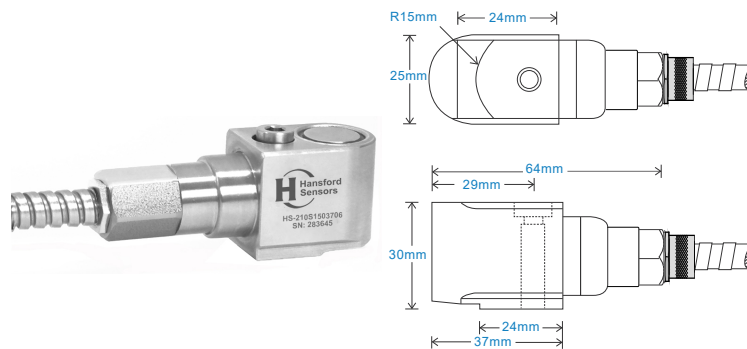

Connection Details

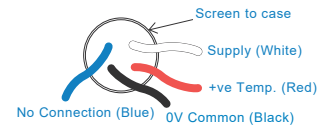

Technical Performance

Temperature Output	10 mV/°C standard 100°C - Option 150°C
Isolation	Base isolated

Mechanical

Case Material	Stainless Steel
Mounting Torque	8Nm
Mounting Bolt provided	see: 'How To Order' table x 30mm long
Weight	125gms (nominal) body only
Maximum Cable Length	1000 metres
Standard Cable Length	5 metres
Screened Cable	Polyolefin HFFR - length to be specified with order
Mounting Threads	see: 'How To Order' table

Electrical

Operating Voltage	4-30 VDC
-------------------	----------

Environmental

Operating Temperature Range	-55 to see: 'How To Order' table for max
Sealing	IP68
EMC	EN61326-1:2013

Applications

Fans, Motors, Pumps, Compressors,
Centrifuges, Conveyors, Air Handlers,
Gearboxes, Rolls, Dryers, Presses,
Cooling, VAC, Spindles, Machine Tooling,
Process Equipment

Vibration sensor should be firmly fixed to a flat surface
(spot face surface may be needed to be produced and
cable anchored to sensor body.)

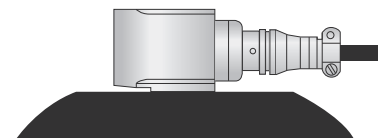

How To Order

Product Prefix HS - Hansford Sensors	Product Series 210 - Industrial Temperature Sensor											
H	S	2	1	0	S	X	X	X	X	X	X	X
Extra Options (if required) S - 90° Side Exit		Temperature Range 100 - 0-100°C 150 - 0-150°C				Connector 37 - 4 Core Screened Polyolefin HFFR with Protective Conduit 52 - 3 Pin MS				Mounting Threads 02 - ¼-28" UNF Male 06 - M6 x 1mm Male 08 - M8 x 1.25mm Male		



www.hansfordsensors.com
sales@hansfordsensors.com

We reserve the right to alter the specification of this product without prior notice
TS991U

