

## SF15 - Series Earth Leakages

The SF15 is a single phase heavy duty industrial earth leakage circuit breaker available as a surface mount and CBI mini rail mount device. This earth leakage circuit breaker is available with earth leakage sensitivity of 30 mA.

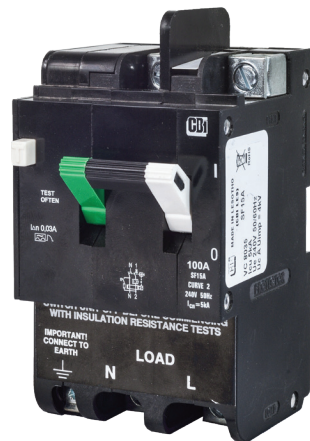

**SF15A**  
Mini Rail & Surface  
Mount

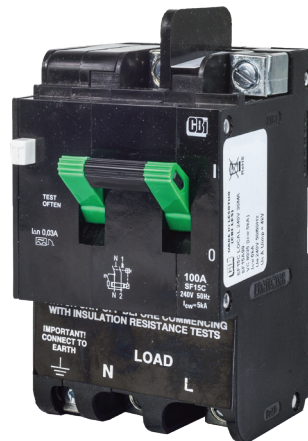

**SF15C**  
Mini Rail & Surface  
Mount

### Features

- Hydraulic-magnetic technology
- 100% rating capability, independent of ambient temperature
- VC 8035 compliant
- AS/NZS 3111 and AS/NZS 3190 compliant
- Immune to pulsating DC load current
- Ratings 10 to 100 A
- Earth leakage sensitivity 30 mA, 50 mA, 250 mA, 375 mA, 500 mA, 1000 mA
- Single pole plus switched neutral earth leakage protection
- Precision tripping characteristics
- Can be switched on immediately after tripping
- Suitable to use for electrical isolation

### Applications

- Mining, heavy industrial and commercial applications requiring high sensitivity earth leakage protection from electrical shock and fire hazards
- Telecom / datacom equipment
- Lighting control
- UPS equipment
- Alternative energy equipment
- Mobile power generation equipment
- Railway signalling and infrastructure

### Approvals

VC 8035



AS/NZS 3111



AS/NZS 3190

**Hydraulic-Magnetic Circuit Breakers 100% rated, unaffected by ambient temperature**

## SF15 - Series Earth Leakages

### Technical Data

Product Type	SF15A	SF15C
Approvals	VC 8035	
Number of Poles	1+N	1+N
Standard Ampere Ratings	10 to 100 A	60, 100 A
Sensitivity	30 mA	30 mA
Rated Voltage	240 V	240 V
Rated Interrupting/ Withstand Capacity	5 kA -	- 5 kA
Time Delay Curves	2	-

Product Type	SF15A	SF15C
Approvals	AS/NZS 3111, AS/NZS 3190	
Number of Poles	1+N	1+N
Standard Ampere Ratings	10 to 100 A	60, 100 A
Sensitivity	30 mA, 50 mA, 100 mA, 250 mA, 375 mA, 500 mA, 1000 mA	30 mA
Rated Voltage	110 / 240 V	240 V
Rated Interrupting / Withstand Capacity	6 kA -	- 6 kA
Time Delay Curves	2	-

Product Type	SF15
Operating Temperature Range	-40 °C to +85 °C
Mounting Options	CBI mini rail, surface mount
Time Delay Curves	2 (A version only)
Endurance	1500 electrical operations (AS/NZS 3111, AS/NZS 3190)
Dielectric Strength	1480 V (single pole) / 1830 V (multi pole), 50 Hz for one minute after testing
Weight	500 g (unpacked)
Humidity	35 to 85% relative
Altitude	Certification tests done at altitude ≈ 2000 metres. Will operate at higher altitudes.
Shock	16 G (IEC 600068-2-27)
Vibration	2 G (IEC 600068-2-27) (sinusoidal wave)
Flammability	I3 - Ignition does not persist at 850 °C after glow wire is withdrawn with an oxygen index of ≥ 28
Toxicity	F1 - Smoke index of ≤ 20 which determines the fume class
Pollution Degree	PD2 - Normally only non-conductive pollution occurs. Temporary conductivity caused by condensation is to be expected.

Earth Leakage	Wire Size mm <sup>2</sup> (IEC)	Torque (IEC)	Comments
1+N	0.75 - 35 mm <sup>2</sup>	2.5 Nm	Pozidriv #2 Combi head

## SF15 - Series Earth Leakages

### Long Code

Example Code: S-F-15-AE--2-100A-30mA-240V

Group	1	2	3	4	5	6	7	8	9	10
Requirement	S Frame	Type F	1 pole + N	Overload	No auxiliary	Medium delay curve 2	Current rat- ing 100 A	Sensitivity 30 mA	Voltage 240 Vac	No special termination
Long Code	S	F	15	AE	-	2	100A	30mA	240V	-

### Ordering Information

Group 1: Frame Type	Code	Description	Comments
	S	65 mm wide earth leakage	
Group 2: Product Type	Code	Description	Comments
	F	240 Vac, 6 kA	
Group 3: No of Poles	Code	Description	Comments
	15	Single pole plus switched neutral (1+N)	SF15
Group 4: E-L Type	Code	Description	Comments
	AE	Overload (auto tripping)	White and green handle
	CE	Switch disconnecter	Green handle
Group 5: Auxiliary / Additional Pole	Code	Description	Comments
	-	Not applicable	Use this code if no auxiliary used
	A	Auxiliary switch	
Group 6: Time Delays	Code	Description	
	2	Medium time delay	
Group 7: Current Ratings	Code / Description		Comments
	10, 15, 16, 20, 30, 40, 50, 60, 80, 100 A		SF15A Ratings available vary depending on certification * Other ratings are available as special orders. Check availability.
	60, 100 A		SF15C
Group 8: Sensitivity	Code	Description	Comments
	30mA	30 mA	Standard
	50mA	50 mA	Standard
	100mA	100 mA	Standard
	250mA	250 mA	Standard
	375mA	375 mA	Standard
	500mA	500 mA	Standard
1000mA	1000 mA	Standard	
Group 9: Voltage	Code	Description	Comments
	240 V	240 Vac	
Group 10: Special Termination	Code	Description	Comments
	-	No special termination	

*For options not listed, please contact CBI*

# SF15 - Series Earth Leakages

## Time Delay Curves

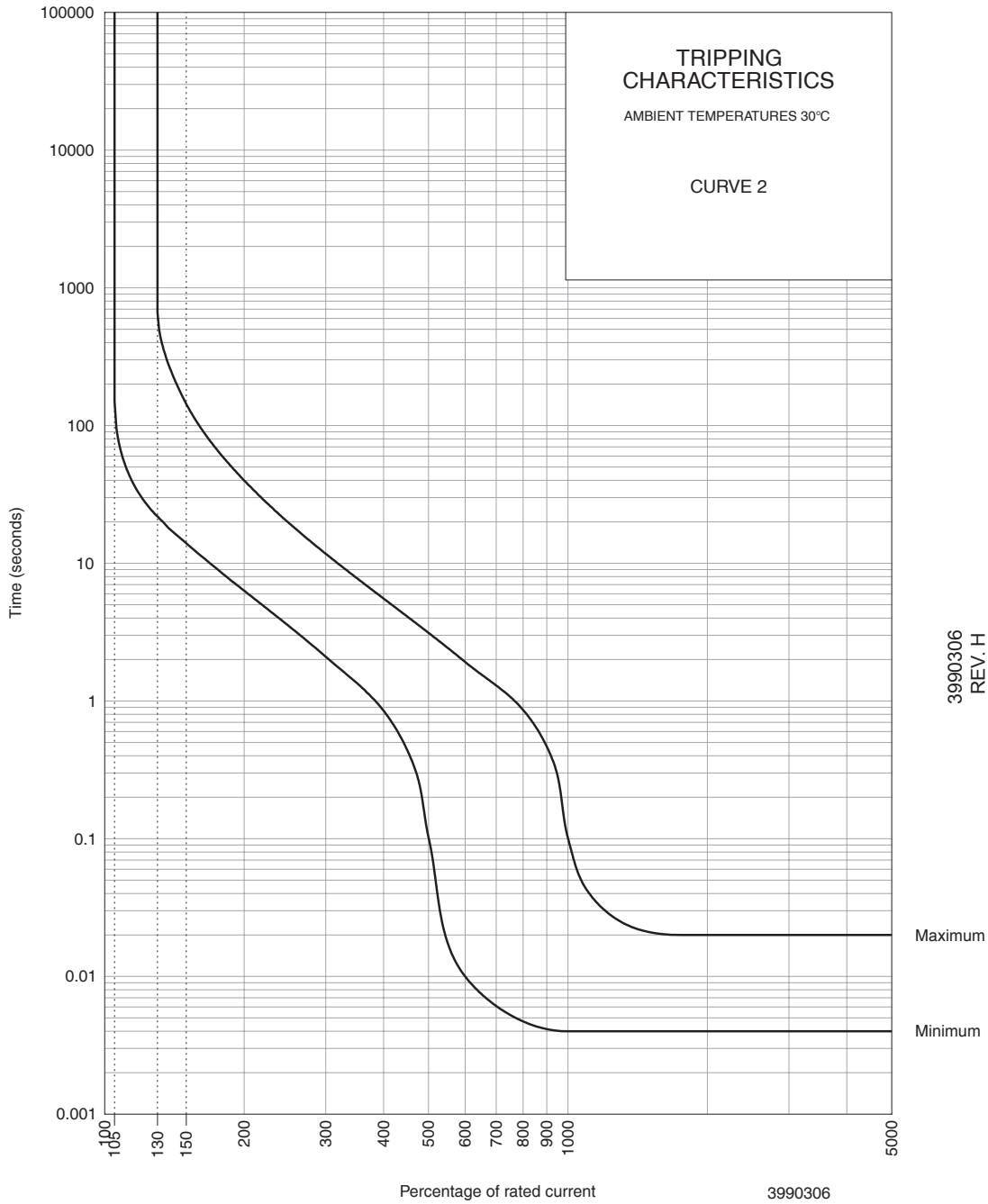

PERCENTAGE OF RATED CURRENT	105%	130%	145%	150%	200%	300%	400%	500%	600%	700%	800%	900%	1000%	2000%
MINIMUM TRIP TIME IN SECONDS	NO TRIP	22	15.4	14	6.3	2.1	0.85	0.1	0.001	0.006	0.005	0.041	0.004	0.004
MAXIMUM TRIP TIME IN SECONDS	NO TRIP	660	180	144	40	12	5.5	3	1.92	1.3	0.86	0.47	0.1	0.02

\* The published time delay curves are generated at 30°C ambient temperature with the circuit breaker mounted in the up-right position. The “must hold”, “must trip” and “instantaneous trip” current values are not affected by temperature, although delay time for the other operating current values may have to be adjusted using the temperature compensation curve which is available on request.

# SF15 - Series Earth Leakages

## Outline Dimensions: Dual Mount

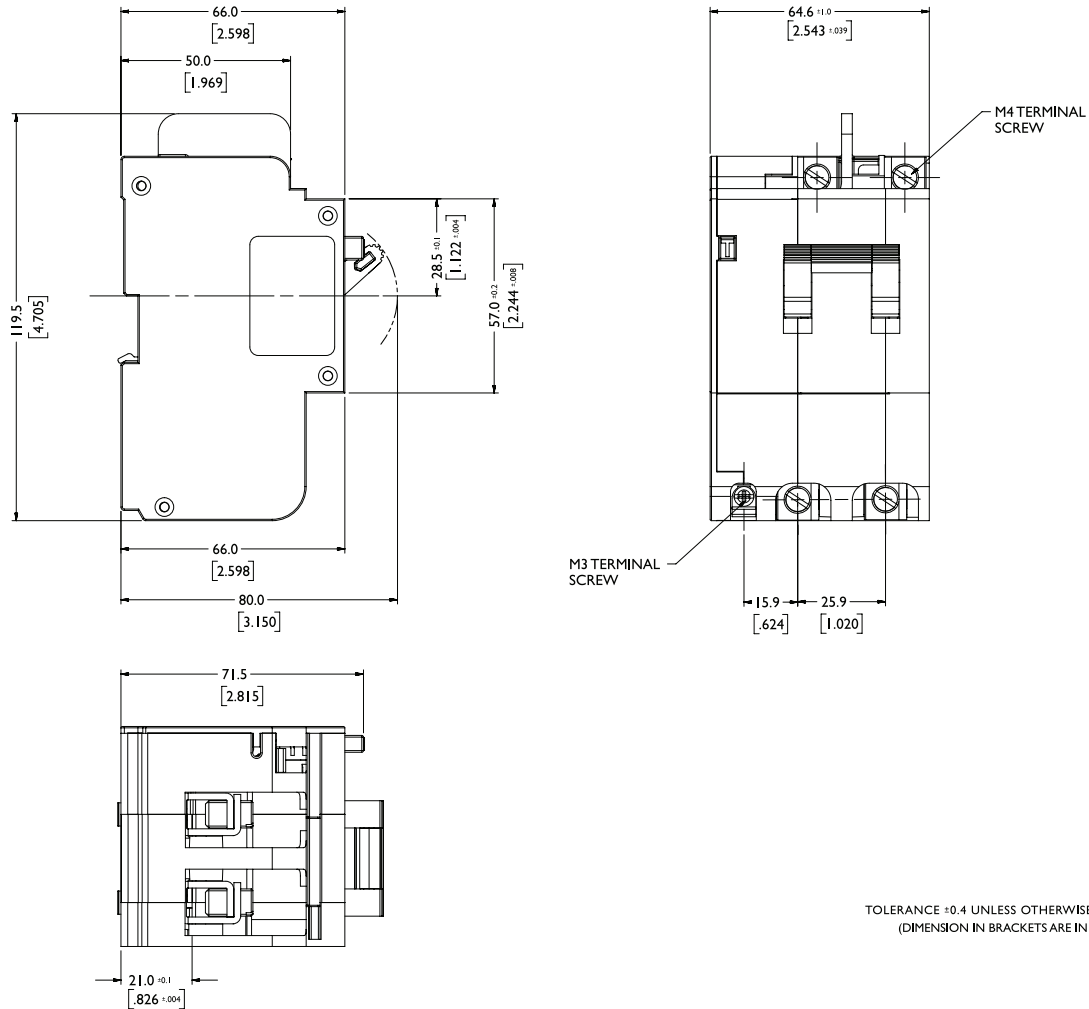

TOLERANCE  $\pm 0.4$  UNLESS OTHERWISE SPECIFIED  
(DIMENSION IN BRACKETS ARE IN INCH)

Please review our Customer Terms and Conditions on [www.cbi-lowvoltage.co.za](http://www.cbi-lowvoltage.co.za)

All rights reserved. Unless otherwise indicated, all materials on these pages are copyrighted by CBI (Pty) Ltd. No part of these pages, either text or image may be used for any purpose other than personal use. Therefore, reproduction, modification, storage in a retrieval system or retransmission, in any form or by any means, electronic, mechanical or otherwise, for reasons other than personal use, is strictly prohibited without prior written permission. CBI (Pty) Ltd reserves the right to alter any details of this document without notice and while every effort is made to ensure the accuracy of the content, no warranty is given as to the accuracy of this document and no responsibility will be accepted for error or misinterpretation and any resulting loss.

### AUSTRALIA

**CBI-electric: Australia**  
27 Wedgewood Rd, Hallam  
Victoria 3803 Australia  
Tel: +61 3 8752 9300  
Fax: +61 3 9796 5407  
Email: [sales@cbi-electric.com.au](mailto:sales@cbi-electric.com.au)  
Website: [www.cbi-electric.com.au](http://www.cbi-electric.com.au)

### SOUTH AFRICA

**CBI-electric: low voltage**  
Tripswitch Drive Elandsfontein  
Gauteng South Africa  
Tel: +27 11 928 2000  
Fax: + 27 11 392 2354  
Email: [cbi@cbi-electric.com](mailto:cbi@cbi-electric.com)  
[internationalsales@cbi-electric.com](mailto:internationalsales@cbi-electric.com)  
Website: [www.cbi-lowvoltage.com](http://www.cbi-lowvoltage.com)

### USA

**CBI-electric: North America**  
35 E. Uwchlan Ave Suite 328  
Exton PA 19341 USA  
Tel: +1 610 524 9949  
Fax: +1 610 524 9945  
E-mail: [info@cbibreakers.com](mailto:info@cbibreakers.com)  
Website: [www.cbibreakers.com](http://www.cbibreakers.com)